

# INSTRUCTIONS

*Robert Sorby*

## CUTTER HOLDER (CODE: 472)

The 472 cutter holder is very easy to use. The end without the clamp is used to sharpen scraper cutters such as the RS200C. Using the screw supplied attach the cutter and set the ProEdge table (or the table on a grinder) to 90 degrees. Place the holder flat on the table, push the tip into the belts and sharpen the straight face. Slacken the tip and rotate the cutter to sharpen the curved faces. For cutters like the RS232C and RS233C use the same end but set the table to 80 degrees.

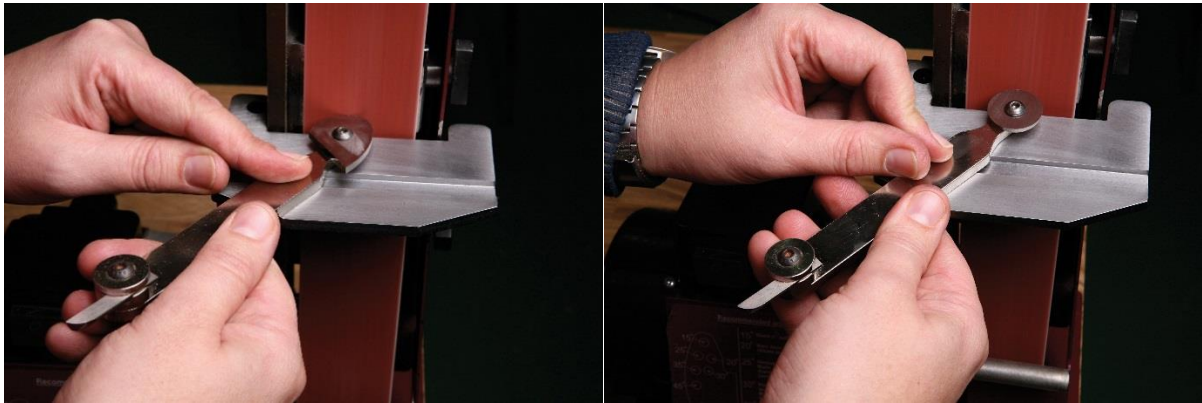

The end with the clamp is used to sharpen the RS211C and RS212C cutters (see picture below). Clamp the cutter in the holder with the flat top of the cutter facing up. Set the table to 80 degrees and place the holder flat on the table and sharpen the tip.



Do not apply too much pressure when sharpening HSS cutters – they only require a light touch.

**Please note: This cutter holder is not compatible with TurnMaster. To re-profile the bevel edge on TurnMaster cutters use the RTSM-TH.**